

WHITELINE PLUS

LOW SPEED RIDE QUALITY
HIGH SPEED CHASSIS CONTROL

350Z traction control - W92994

One of the most noticeable compromises in Nissan suspension performance is the 4 points on the rear subframe. The bushes are a very compliant hydraulic filled rubber bush that permits squirming of the rear end under bump/turn/acceleration. Whiteline has recently added to the range of subframe kits that currently covers 240SX/ 300Z with a proven fix for the Nissan 350Z and G35 platform.

W92994 features the latest technology **WHITELINE PLUS** polyurethane bushings, steel componentry and very informative install guide. The translucent black bushings boast voiding points so that elements of compliance is achieved. The kit replaces all 4 point of the rear cradle on a 350Z or G35 Infiniti and results in a more responsive, predictable and enjoyable driving 'Z'



Key Benefits of WHITELINE PLUS

The quality of ride of rubber, with the performance of solid links.

Long lasting durability.

Resistant to chemicals, oils and weathering.

Enhanced handling, steering response and road holding stability.

Increased traction and power transfer



WHITELINE PLUS is a range of 'NO COMPROMISE' polyurethane suspension bushings and components. By 'NO COMPROMISE' we are referring to the polyurethane's ability to provide the quality ride of rubber at low speeds and at higher speeds to become firmer, (somewhat progressive) when under cornering, accelerating and braking loads, for **CHASSIS CONTROL** and improved handling.

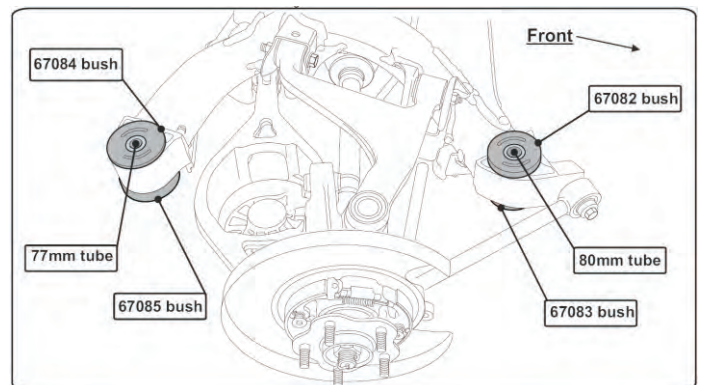

WHITELINE PLUS

For specialist advice in Australia call Free call 1800 040 003
Whiteline direct on ph: 61-2-4340-2355 Fax: 61-2-4340 2466

Web Site: <http://www.whiteline.com.au> E-mail: sales@whiteline.com.au

Snail mail: 4 Warringah Close, Somersby NSW 2250. Australia
ABN 99 124 177 297